

AREA IN PLOTS			
AREA PNO	AREA IN SQ.M.	PNO	AREA IN SQ.M.
1	371	21	305
2	287	22	312
3	314	23	521
4	317	24	416
5	545	25	553
6	615	26	697
7	362	27	466
8	382	28	477
9	369	29	370
10	285	30	398
11	448	31	355
12	212	32	313
13	237	33	232
14	265	34	232
15	278	35	313
16	471	36	299
17	236	37	338
18	215	38	318
19	233	39	560
20	382	40	409

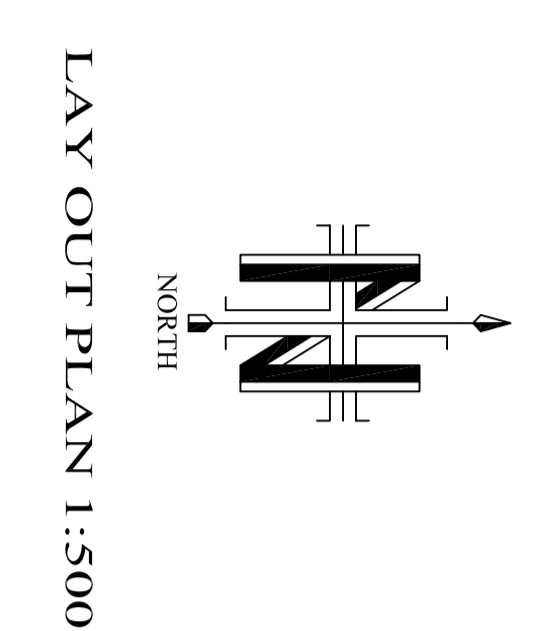
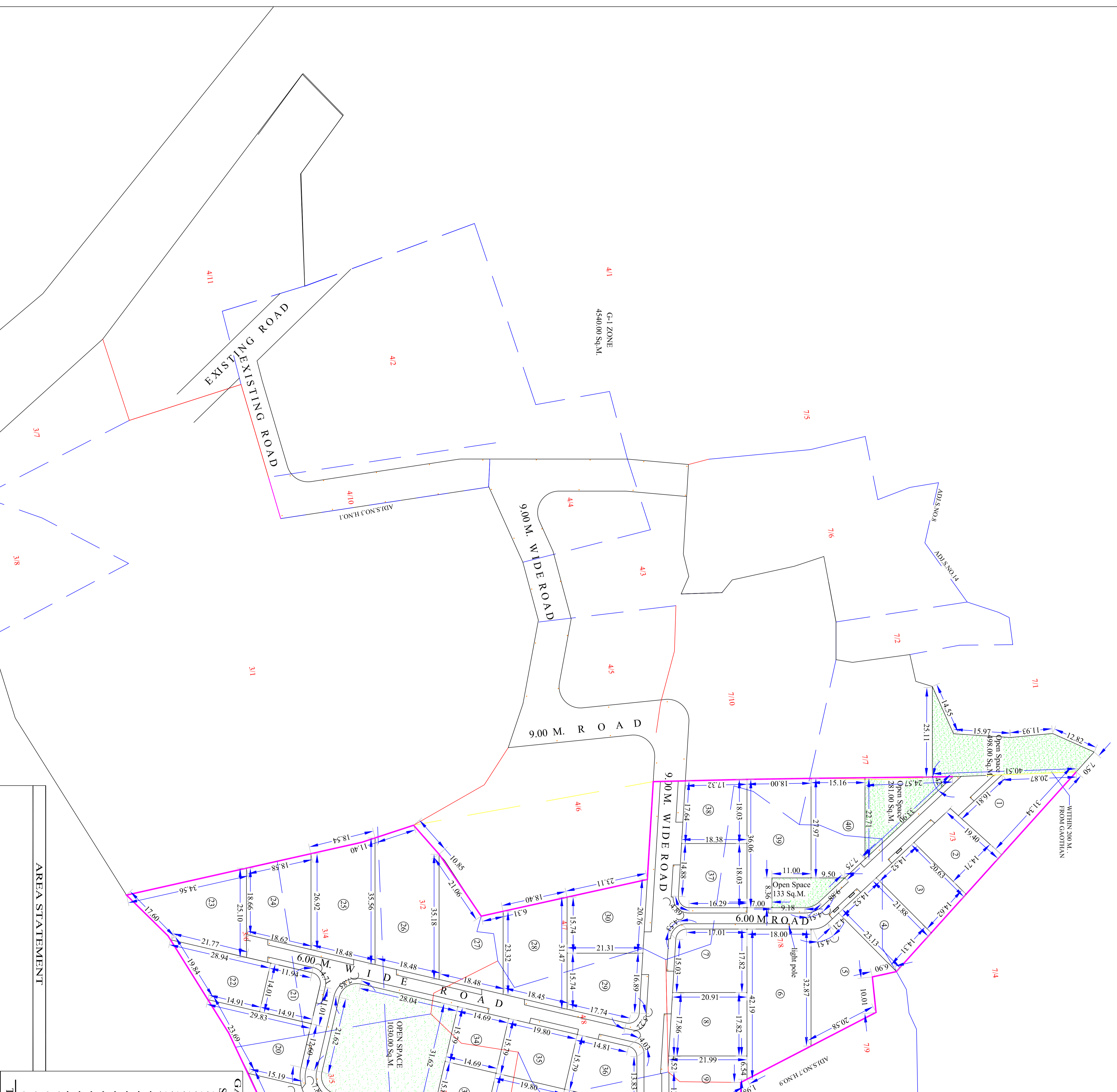

**AREA STATEMENT**

TOTAL LAY OUT AREA	--28135.57 Sq.M.
AREA WITHIN OUT SIDE 200 M. FROM GAOTIHAN. :- 8726.5700Sq.M.	
AREA WITHIN 200 M.FROM GAOTIHAN	-- 19409.00 Sq.M.
AREA UNDER LAYOUT	-- 19409.00 Sq.M.
AREA UNDER PLOTS	--15080.00sq.M.
AREA UNDER OPEN SPACE	--1189.00 Sq.M.
AREA UNDER INTERNAL ROAD	--3140.00Sq.M.

**GAT NO. WISE STATEMENT**

S.NO. H.NO.	AREA IN Hct.	
3	2	0-14.0
3	3	0-14.0
3	4	0-15.0
3	5	0-10.0
3	6	0-12.5
4	3	0-10.4
4	4	0-09.0
4	5	0-14.0
4	7	0-08.5
4	8	0-22.0
4	9A	0-18.8
4	9B	0-11.2
4	10	0-12.0
7	3	0-20.8
7	7	0-15.0
7	8	0-37.7
10		0-37.0
<b>TOTAL AREA :- 2.81-7</b>		

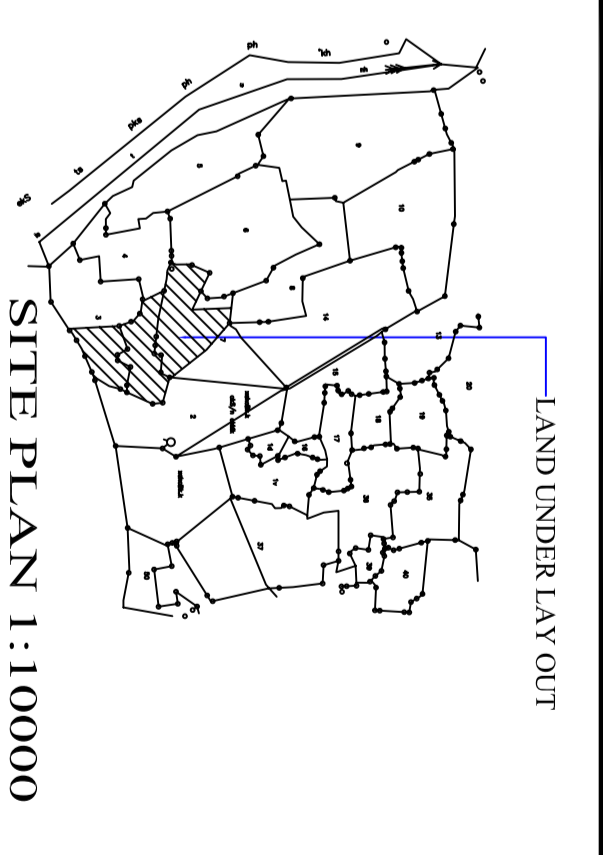

**AREA WITHIN 200 MTS OF GAOTIHAN**  
 S.NO. (PARTY)-7/3, 7/7, 7/10,  
 S.NO.(FULL)-3/2, 3/3, 3/4, 3/5, 3/6, 4/7  
 4/8, 4/9A, 4/9B, 7/8.

**PROPOSED RESIDENTIAL LAY OUT OF**  
 S.NO.3/2,3,4,5,6, S.NO.4/3,4,5,7,8,9A,9B,10,  
 S.NO.7/3,7,8,10, VILLAGE--KHARWANADI  
 TAL.KARJAT, DIST.KAIGAD

**APPROVAL BY.**

**OWNER SIGN.**

**ARCHITECT SIGN.**